

# Kettle & Shower Descaler

  
**Jangro**

## Product Usage Guide

Professional



### BB024-50



#### Descaling Steam Irons



**1** Use appropriate PPE as indicated in the Safety Data Sheet and place Safety Signs.

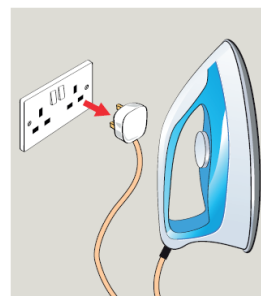

**2** Unplug iron and allow to cool.

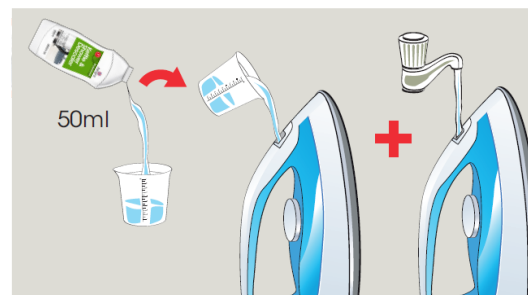

**3** Pour 50ml descaler to iron reservoir and top up with water. Iron to be cool.

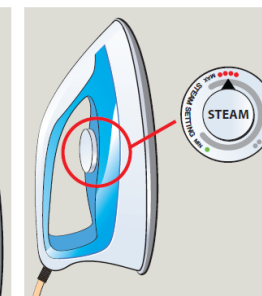

**4** Set control on iron to 'steam' position.

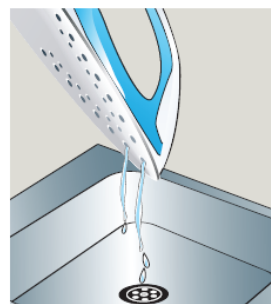

**5** Gently shake iron over sink until solution starts to drain through steam holes.

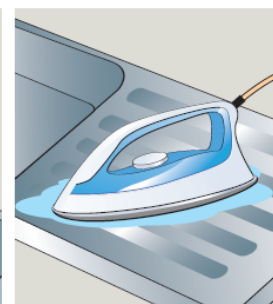

**6** Allow to drain for 30 minutes.

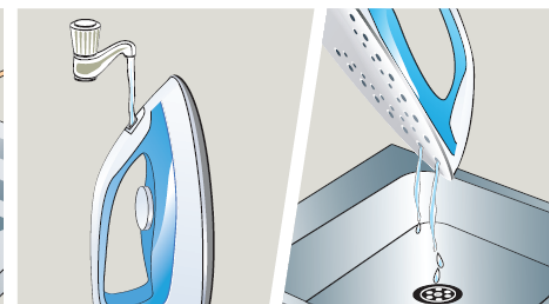

**7** Rinse thoroughly with water and dry.



**8** Once dry remove safety signs.

#### Health & Safety

Please refer to relevant COSHH Safety Data Sheet



Scan for further product details



Refer to your specific equipment user manual before use.

[www.jangro.net](http://www.jangro.net)

# Kettle & Shower Descaler

  
**Jangro**

## Product Usage Guide

Professional



### BB024-50

#### Descaling Shower Heads

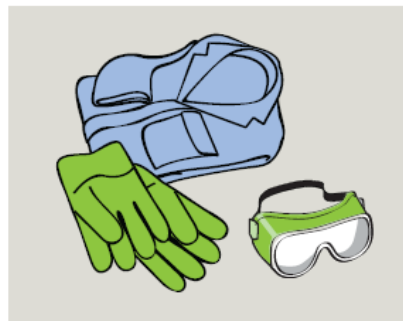

**1** Use appropriate PPE as indicated in the Safety Data Sheet.



**2** Place Safety Signs.



**3** Dilute 50ml descaler to 300ml water into a container.

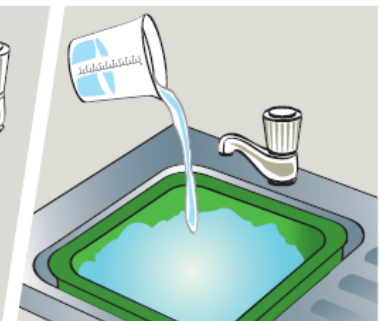

**4** Immerse shower head in solution until scale is removed.



**5** Rinse shower head and container with clean water.

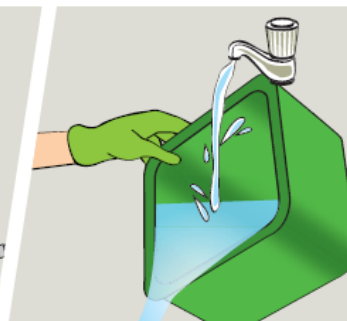

**6** Remove Safety Signs.

#### Health & Safety

Please refer to relevant COSHH Safety Data Sheet



Scan for further product details



Refer to your specific equipment user manual before use.

[www.jangro.net](http://www.jangro.net)

# Kettle & Shower Descaler

## Product Usage Guide

Professional



### BB024-50



#### Descaling Kettles



**1** Use appropriate PPE as indicated in the Safety Data Sheet and place Safety Signs.



**2** Fill kettle two thirds with warm water.

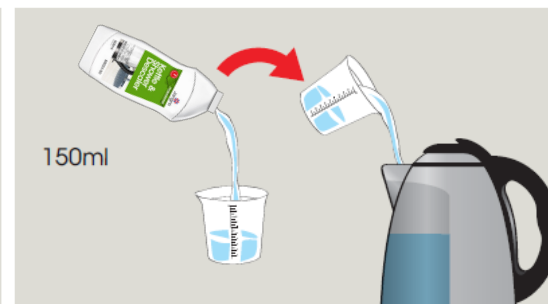

**3** Add 150ml of descaler to kettle.

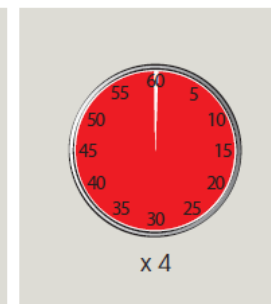

**4** Leave for 4 hours or until fizzing stops.

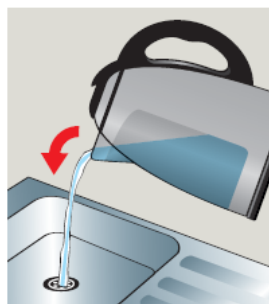

**5** Empty kettle and rinse.



**6** Refill kettle with cold water.



**7** Boil the kettle.

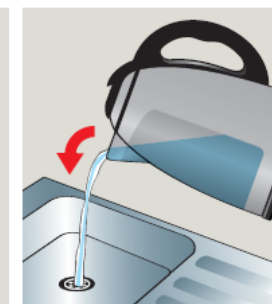

**8** Empty kettle and rinse.



**9** Remove Safety Signs.

#### Health & Safety

Please refer to relevant COSHH Safety Data Sheet



Scan for further product details



Refer to your specific equipment user manual before use.