

# Hard Surface Cleaner



When dosing concentrate chemicals always use the recommended PPE, and always read the labels to check best practice for handling both the undiluted & ready to use solutions.

## Product Usage Guide

### Professional



### BA001-5



#### Damp Mopping

**Recommended Dosage**  
Heavy Soiling  
200ml per 5L of water.  
General Cleaning  
50ml per 5L of water.



**1** Use appropriate PPE as indicated in the Safety Data Sheet and place Safety Signs.



**2** Remove loose debris from surface by sweeping or using a cloth or tissue.



**3** Dilute as per Recommended Dosage table.



**4** Wipe with mop or cloth.



**5** Once surface is dry, remove Safety Signs.

#### Spray Cleaning (Non polished floors)



**1** Use appropriate PPE as indicated in the Safety Data Sheet and place Safety Signs.

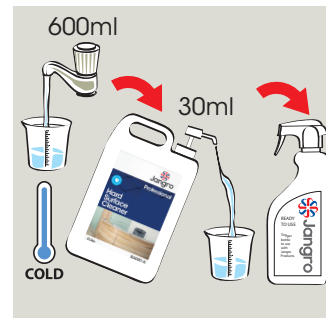

**2** Add 30ml of solution to 600ml of cold water in a trigger spray.



**3** Replace top & gently shake to mix.

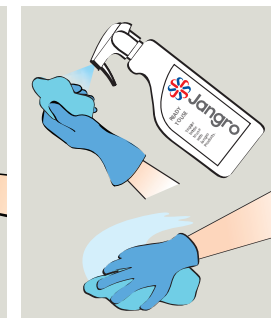

**4** Spray cloth and wipe surface.



**5** Remove Safety Signs.

#### Health & Safety

Please refer to relevant COSHH Safety Data Sheet



Scan for further product details